

**MultiPoint, height-adjustable hinge, European sizes,  
adjustable block frame, ASSA handle system**



## MZ Multi-Purpose Door

High-quality steel doors for internal and external applications







|  |         |
|--|---------|
| Design features                              | 4       |
| MZ multi-purpose door                        | 5       |
| MZ Sentinel Basic multi-purpose doors        | 6       |
| MZ Sentinel MultiPoint multi-purpose doors   | 7       |
| Special equipment                            | 8 – 9   |
| Ordering sizes, frame types, fitting methods | 10 – 14 |
| Hörmann product range                        | 15      |

Copyright: No part or excerpt may be reproduced without our permission. Subject to changes. Some of the doors shown are special versions and may require approval in individual cases.

The architects' programme and further information on Hörmann products can be found in the Internet: [www.hoermann.com](http://www.hoermann.com).

Image on left:  
dm combination distribution centre, Weilerswist

# Design Features

## MZ, MZ Sentinel Basic, MZ Sentinel Multipoint

### Stable quality

Multi-purpose doors for internal and external use have been tried and tested for more than four decades because they are so sturdy, durable, and weather-resistant. We offer them single-leaf, double-leaf and with glazing cut-out on request.

### Door leaves

Hörmann MZ steel doors are very durable and extremely stable thanks to a double-skinned door leaf additionally reinforced with steel.

### Surface

Hörmann exclusively uses galvanized steel which is primed with a high-quality powder coating. This is the prerequisite for a high level of corrosion-protection. Available from 20 units.



### Block frame

On request, MZ doors can also be delivered with a block frame for fitting in the opening or on the wall, including 3-sided sealing profile.

### Bottom edge

With or without threshold (easily-to-remove threshold profile).

### Frame with seal

Corner frame, 2 mm thickness, with allround EPDM seal (included separately) and easy-to-remove threshold profile.



### Thermal and acoustic insulation

Thanks to an all-round seal and door leaf infill, ready-to-fit MZ doors offer good sealing and thermal and acoustic insulation characteristics.

### Hinges (corner frame)

As standard, the multi-purpose doors are equipped with a spring hinge and a construction hinge according to DIN 182272 (MZ-1) or a height-adjustable construction hinge (MZ-1 with block frame, MZ-2, MZ-Sentinel).

### Height-adjustable door leaf

The height-adjustable construction hinge enables fine adjustment of the door leaf afterwards.



# Steel Door MZ

## Single and double-leaf



### Thin rebate

Rebated on 2 sides  
Door leaf thickness  
45 mm



### Door set

Ready-to-fit, with  
corner frame,  
dual handed

### Main function

Multi-purpose door



### Additional function



### Fire-retarding

MZ-1 with  
corner frame and  
full door leaf  
Up to 1000 x 2125 mm  
(H8-5)

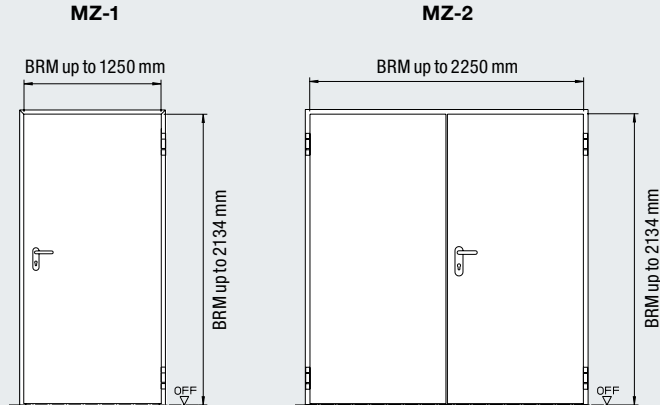

### Standard features

|                              |  |
|------------------------------|--|
| <b>Lock and lever handle</b> | Dual-handed mortice lock with lever/knob,<br>prepared for profile cylinder with deadlock insert<br><br>Black plastic lever handle set with steel core,<br>suitable for profile cylinder and deadlock key |
| <b>Hinges</b>                | One spring hinge<br><br>One height-adjustable construction hinge (MZ-2)<br><br>Block frame in general with height adjustable KO hinge<br>(see sentinel)  |
| <b>Security bolts</b>        | 2 steel bolts (on hinge side)  |
| <b>Fitting in</b>            | - Brickwork<br>- Concrete<br>- Fitting to other wall types on request  |

### MZ-1 performance characteristics

|                            |                                      |
|----------------------------|--------------------------------------|
| <b>Thermal insulation</b>  | $U_D 1.7 \text{ W/m}^2\text{K}^*$    |
| <b>Acoustic insulation</b> | $RW = \text{approx. } 39 \text{ dB}$ |

### Door bottom edges

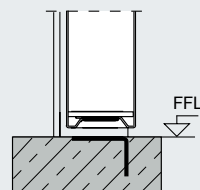

Without threshold

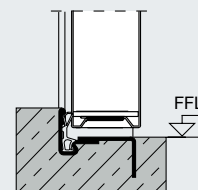

With threshold and seal

### Optional extras

Special equipment Page 8 – 9

\*for doors without glazing with corner frame and all-round seal

# Steel Door

## MZ Sentinel Basic

### Single and double-leaf

*with height-adjustable  
construction hinge*



#### Thin rebate

Rebated on 3 sides  
Door leaf thickness  
45 mm

#### Main function

Multi-purpose door

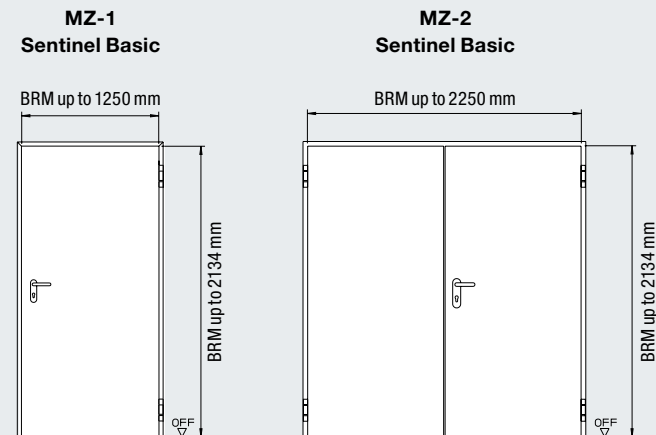

#### Standard features

|                              |   |
|------------------------------|---|
| <b>Frame</b>                 | Special four-sided corner frame, 2.0 mm thick, with all-round EPDM sealing profile and welded-on grouting lugs  |
| <b>Surface</b>               | Door leaves and corner frame made of galvanized material, primed and powder-coated Grey white (based on RAL 9002)   |
| <b>Lock and lever handle</b> | Mortice lock with lever/knob, prepared for profile cylinder, with deadlock insert<br><br>Black plastic lever handle set with steel core, suitable for profile cylinder and deadlock key |
| <b>Hinges</b>                | One spring hinge<br><br>One height-adjustable construction hinge  |
| <b>Security bolts</b>        | 2 steel bolts (on hinge side)   |
| <b>Fitting in</b>            | - Brickwork<br>- Concrete<br>- Fitting to other wall types on request   |

#### MZ-1 performance characteristics

|                            |  |
|----------------------------|--|
| <b>Thermal insulation</b>  | $U_D 1.7 \text{ W/m}^2\text{K}^*$      |
| <b>Acoustic insulation</b> | $RW = \text{approx. } 39 \text{ dB}^*$ |

#### Door bottom edges

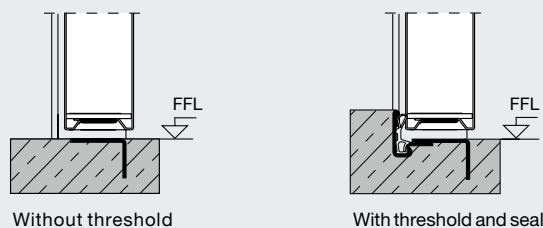

#### Optional extras

Special equipment Page 8 – 9

\*for doors without glazing with corner frame and all-round seal

# Steel Door

## MZ Sentinel MultiPoint

Single-leaf with multiple-point locking

*with height-adjustable  
construction hinge*



### Thin rebate

Rebated on 3 sides  
Door leaf thickness  
45 mm

### Main function



Multi-purpose door

### MZ-1 Sentinel MultiPoint

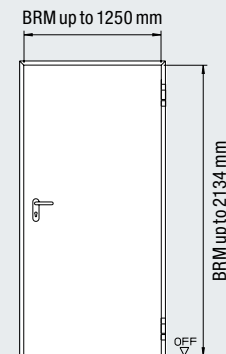

#### Standard features

|                              |  |
|------------------------------|--|
| <b>Lock and lever handle</b> | Surface-mounted, 3-point locking panic systems.<br>Door leaf without interior lock |
| <b>Hinges</b>                | One spring hinge<br>One height-adjustable construction hinge                       |
| <b>Security bolts</b>        | 2 steel bolts (on hinge side)  |

|                   |   |
|-------------------|---|
| <b>Fitting in</b> | - Brickwork<br>- Concrete<br>- Fitting to other wall types on request |
|-------------------|---|

#### Performance characteristics

|                            |  |
|----------------------------|--|
| <b>Thermal insulation</b>  | $U_D 1.7 \text{ W/m}^2\text{K}^*$      |
| <b>Acoustic insulation</b> | $RW = \text{approx. } 39 \text{ dB}^*$ |

#### Door bottom edges

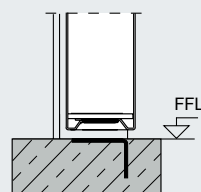

Without threshold

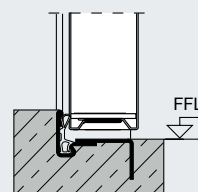

With threshold and seal

#### Optional extras

Special equipment Page 8 – 9

\* for doors without glazing with corner frame and all-round seal

# More design flexibility through varied equipment.

## Make the most of daylight for added illumination

On request, we provide the MZ doors also with glazing on the glazing frame: aluminium natural finish. Glazing beads: on opposite hinge side, on request on hinge side.

Glazing: 7-mm wired glass as standard, on request with 20-mm insulated wired glass.



MZ glazing cut-out (MZ door/MZ-Sentinel)  
View: 230 x 1360 mm



Round glazing (MZ-Sentinel) Ø 300 mm



Glazing cut-out Figure 5 (MZ-Sentinel)



## Ventilation grille

Fitted in the bottom section, doors with ventilation are not suitable for right handing/left handing.



Plastic ventilation grille  
455 x 90 mm



Aluminium ventilation grille  
425 x 75 mm

## Wide-angle spyhole

Spyhole preparation Ø 15 mm. Fitting also available on-site.



## Rain canopy

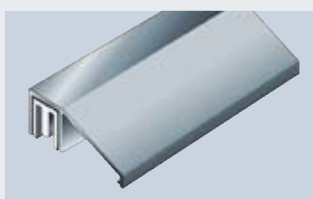

Paintable aluminium, attachable

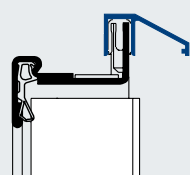

## Door drip

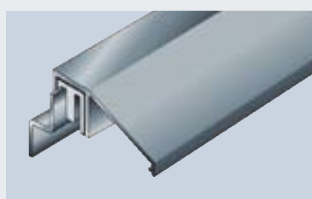

Only for single-leaf MZ doors, screw-on

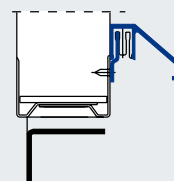



**Hörmann quality means all optional extras are designed for a perfect fit and attractive look for safe and long-life performance.**

**Lever handle sets**

The handles as lever, lever/knob or anti-panic handle sets are available with short escutcheon or rose escutcheon in plastic, aluminium or stainless steel. Of course, they can also be equipped with all other conventional sets.



Lever handle set, PC/DL



Lever/knob handle set, PC

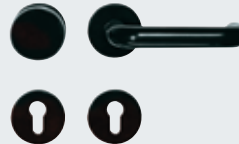

Lever/knob handle set, PZ rose escutcheon



ASSA lock 565, only for MZ Sentinel Basic doors with block frame and adjustable side frames

**Closing devices**

Multi-purpose doors are generally self-locking. In single leaf doors, this occurs as standard with a spring hinge. Depending on the size, equipment, use or fitting, we also offer you ex-factory single-leaf doors with the exclusive slide rail door closer HDC 35.



Exclusive slide rail door closer HDC 35 //NEW  
For single-leaf doors (on request also for double-leaf doors).

**Locks**

Hörmann's dual-handed anti-panic lock prepared for profile cylinder with lever/knob or with split spindle and lever handle can, of course, be used with profile cylinders (PC) and deadlocks (DL) through the use of a clip.

A deadlock key is included. Also available for round cylinders. Profile cylinder on request: 31.5 + 31.5 mm with 3 keys.

**MZ Sentinel Basic**



Anti-panic push bar



Anti-panic handle bar

**MZ Sentinel MultiPoint**



3-point, surface-mounted anti-panic handle bar (Type A)



3-point, surface-mounted anti-panic handle bar (Type B)

**Special equipment**



Steel threshold profile



Aluminium threshold with seal

# Frame types, fitting methods, ordering sizes

## Corner frame

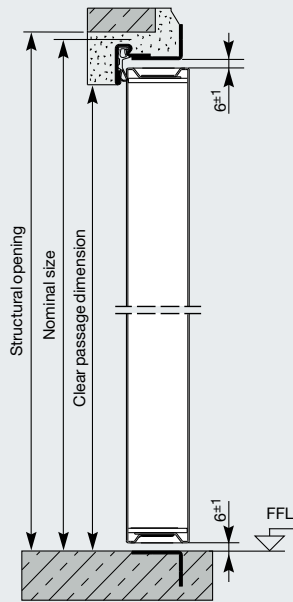

Shown without  
threshold profile

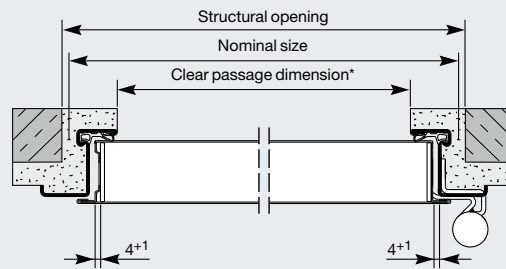

\* With an opening angle of 90° and without handles and levers,  
the clear passage width is reduced by + / -25 mm.

### European Sizes

#### According to nominal size

| Nominal size<br>Ordering size<br>width × height | Clear passage<br>width × height | Structural opening<br>width × height |
|---|---------------------------------|--------------------------------------|
| <b>Single-leaf</b>                              |                                 |                                      |
| 750 × 2000                                      | 682 × 1966                      | 760 × 2005                           |
| 875 × 1875                                      | 807 × 1841                      | 885 × 1880                           |
| 875 × 2000                                      | 807 × 1966                      | 885 × 2005                           |
| 875 × 2125                                      | 807 × 2091                      | 885 × 2130                           |
| 1000 × 2000                                     | 932 × 1966                      | 1010 × 2005                          |
| 1000 × 2125                                     | 932 × 2091                      | 1010 × 2130                          |
| 1125 × 2125                                     | 1057 × 2091                     | 1135 × 2130                          |
| 1250 × 2000                                     | 1182 × 1966                     | 1260 × 2005                          |
| 1250 × 2125                                     | 1182 × 2091                     | 1260 × 2130                          |
| <b>Double-leaf</b>                              |                                 |                                      |
| 1500 × 2000                                     | 1432 × 1966                     | 1510 × 2005                          |
| 1750 × 2000                                     | 1682 × 1966                     | 1760 × 2005                          |
| 2000 × 2000                                     | 1932 × 1966                     | 2010 × 2005                          |
| 2000 × 2125                                     | 1932 × 2091                     | 2010 × 2130                          |

#### According to structural opening

| Structural opening<br>Ordering size<br>width × height | Clear passage<br>width × height |
|---|---------------------------------|
| <b>Single-leaf</b>                                    |                                 |
| 800 × 2000  | 722 × 1961                      |
| 800 × 2100  | 722 × 2061                      |
| 900 × 2000  | 822 × 1961                      |
| 900 × 2100  | 822 × 2061                      |
| 1000 × 2000   | 922 × 1961                      |
| 1000 × 2100   | 922 × 2061                      |
| 1200 × 2000   | 1122 × 1961                     |
| 1200 × 2100   | 1122 × 2061                     |
| <b>Double-leaf</b>                                    |                                 |
| 1600 × 2000   | 1522 × 1961                     |
| 1800 × 2000   | 1722 × 1961                     |
| 2000 × 2000   | 1922 × 1961                     |
| 2000 × 2100   | 1922 × 2061                     |

**Anchor spacings**

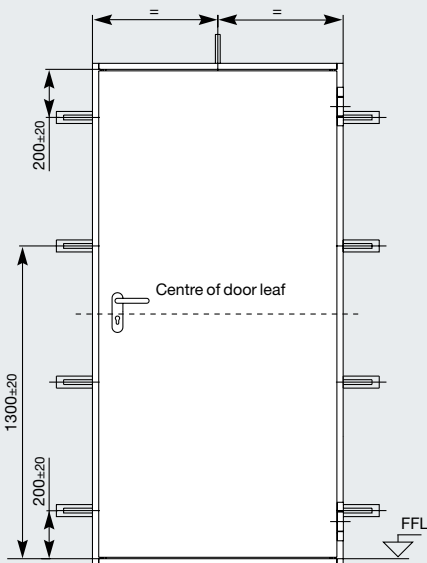

**Frame types**

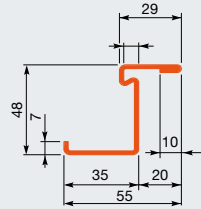

Standard corner frame, on request with counter frame

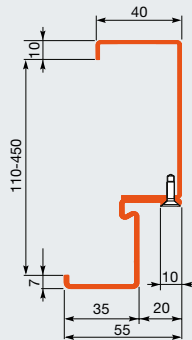

Standard special corner frame, on request with counter frame

**Fitting methods**

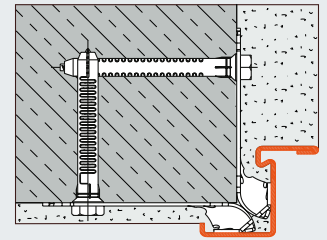

Fitting with grouting lugs

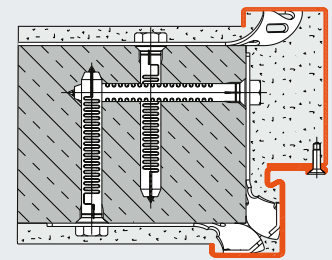

Fitting with grouting lugs

**Corner frames**

Counter frame, 3-sided, screw-on, 1.5 mm thick, galvanized, wall widths 110 - 450 mm available on request

**According to clear passage**

| Clear passage<br>Ordering size<br>width × height | Structural opening<br>width × height |
|--|--------------------------------------|
| <b>Single-leaf</b>                               |                                      |
| 800 × 1850                                       | 878 × 1889                           |
| 800 × 2000                                       | 878 × 2039                           |
| 800 × 2025                                       | 878 × 2064                           |
| 800 × 2100                                       | 878 × 2139                           |
| 850 × 1850                                       | 928 × 1889                           |
| 850 × 2000                                       | 928 × 2039                           |
| 850 × 2025                                       | 928 × 2064                           |
| 850 × 2100                                       | 928 × 2139                           |
| 1000 × 1850                                      | 1078 × 1889                          |
| 1000 × 2000                                      | 1078 × 2039                          |
| 1000 × 2025                                      | 1078 × 2064                          |
| 1000 × 2100                                      | 1078 × 2139                          |
| <b>Double-leaf</b>                               |                                      |
| 1600 × 2000                                      | 1678 × 2039                          |
| 1800 × 2000                                      | 1878 × 2039                          |
| 2000 × 2000                                      | 2078 × 2039                          |
| 2000 × 2100                                      | 2078 × 2139                          |

# Frame types, fitting methods, ordering sizes

## Block frame type N and type S

### Block frame for fitting in the opening

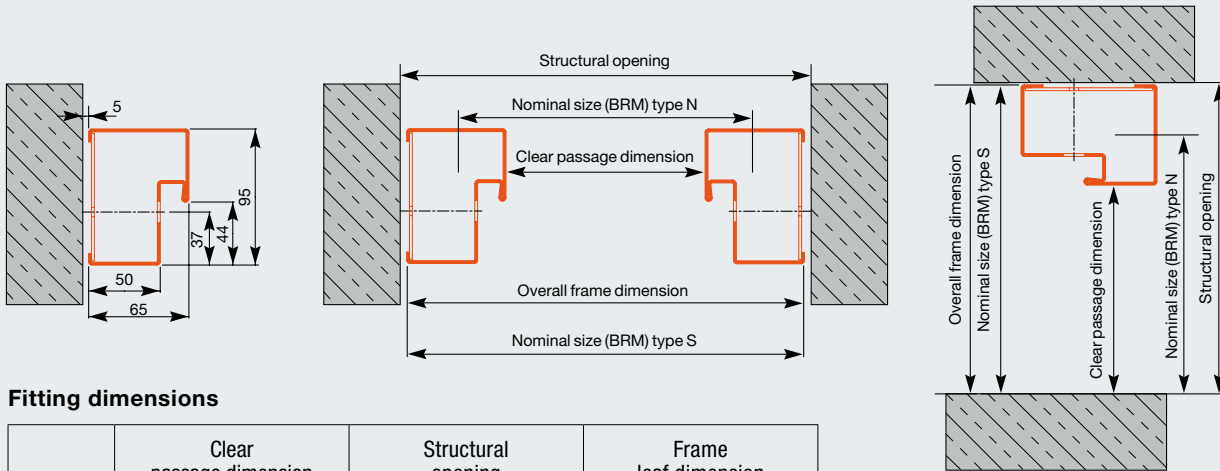

### Fitting dimensions

|               | Clear passage dimension (LD) | Structural opening (LM) | Frame leaf dimension (RAM) |
|---------------|------------------------------|-------------------------|----------------------------|
| <b>Type N</b> |                              |                         |                            |
| Width         | BRM width -68                | BRM width +82           | BRM width +72              |
| Height        | BRM height -34               | BRM height +41          | BRM height +36             |
| <b>Type S</b> |                              |                         |                            |
| Width         | BRM width -130               | BRM width +10           | BRM width                  |
| Height        | BRM height -65               | BRM height +5           | BRM height                 |

### European Sizes

#### According to nominal size

| BRM type N<br>Ordering size<br>width × height | Clear passage<br>dimension<br>width × height | Structural opening<br>(fitting in<br>the opening)<br>width × height | Structural opening<br>(Fitting in front of<br>the opening)<br>width × height |
|---|--|---|--|
| <b>Single-leaf</b>                            |  |   |  |
| 750 × 2000                                    | 692 × 1969                                   | 832 × 2039  | 692 × 1971   |
| 875 × 1875                                    | 817 × 1844                                   | 957 × 1914  | 817 × 1846   |
| 875 × 2000                                    | 817 × 1969                                   | 957 × 2039  | 817 × 1971   |
| 875 × 2125                                    | 817 × 2094                                   | 957 × 2164  | 817 × 2096   |
| 1000 × 2000                                   | 942 × 1969                                   | 1082 × 2039   | 942 × 1971   |
| 1000 × 2125                                   | 942 × 2094                                   | 1082 × 2164   | 942 × 2096   |
| 1125 × 2125                                   | 1067 × 2094                                  | 1207 × 2164   | 1067 × 2096  |
| 1250 × 2000                                   | 1192 × 1969                                  | 1332 × 2039   | 1192 × 1971  |
| 1250 × 2125                                   | 1192 × 2094                                  | 1332 × 2164   | 1192 × 2096  |
| <b>Double-leaf</b>                            |  |   |  |
| 1500 × 2000                                   | 1442 × 1969                                  | 1582 × 2039   | 1442 × 1971  |
| 1750 × 2000                                   | 1692 × 1969                                  | 1832 × 2039   | 1692 × 1971  |
| 2000 × 2000                                   | 1942 × 1969                                  | 2082 × 2039   | 1942 × 1971  |
| 2000 × 2125                                   | 1942 × 2094                                  | 2082 × 2164   | 1942 × 2096  |

#### According to structural opening

| Structural opening<br>Ordering size<br>width × height | Clear passage<br>dimension<br>(fitting in<br>the opening)<br>width × height | Clear passage<br>dimension<br>(Fitting in front of<br>the opening)<br>width × height |
|---|---|--|
| <b>Single-leaf</b>                                    |   |  |
| 800 × 2000  | 660 × 1930  | 790 × 1995   |
| 800 × 2100  | 660 × 2030  | 790 × 2095   |
| 900 × 2000  | 760 × 1930  | 890 × 1995   |
| 900 × 2100  | 760 × 2030  | 890 × 2095   |
| 1000 × 2000   | 860 × 1930  | 990 × 1995   |
| 1000 × 2100   | 860 × 2030  | 990 × 2095   |
| 1200 × 2000   | 1060 × 1930   | 1190 × 1995  |
| 1200 × 2100   | 1060 × 2030   | 1190 × 2095  |
| <b>Double-leaf</b>                                    |   |  |
| 1600 × 2000   | 1460 × 1930   | 1590 × 1995  |
| 1800 × 2000   | 1660 × 1930   | 1790 × 1995  |
| 2000 × 2000   | 1860 × 1930   | 1990 × 1995  |
| 2000 × 2100   | 1860 × 2030   | 1990 × 2095  |

**Block frame for fitting on the wall**

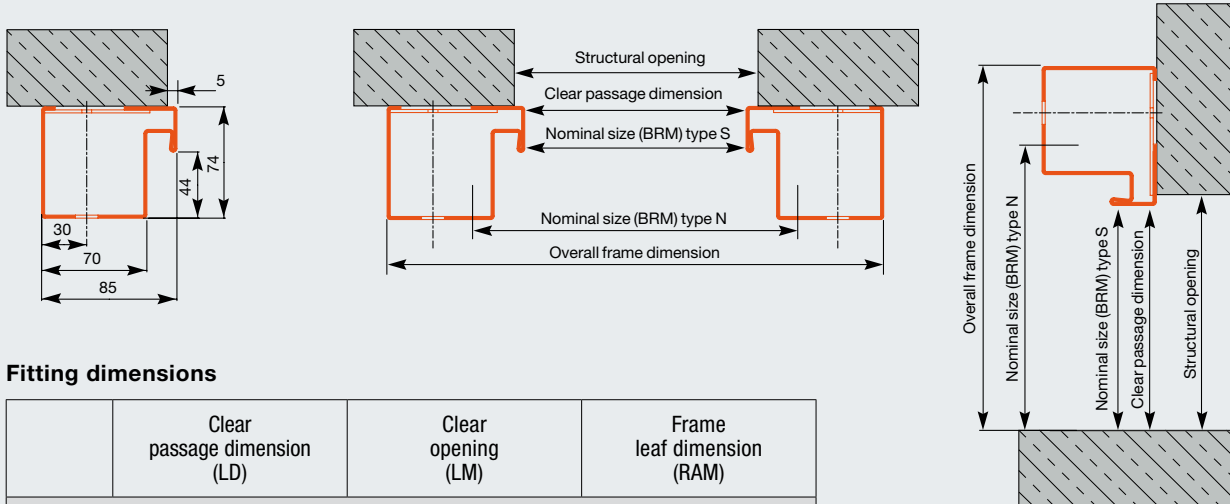

**Fitting dimensions**

|               | Clear passage dimension (LD) | Clear opening (LM) | Frame leaf dimension (RAM) |
|---------------|------------------------------|--------------------|----------------------------|
| <b>Type N</b> |                              |                    |                            |
| Width         | BRM width -58                | BRM width -58      | BRM width +102             |
| Height        | BRM height -29               | BRM height -29     | BRM height +51             |
| <b>Type S</b> |                              |                    |                            |
| Width         | BRM width                    | BRM width          | BRM width +170             |
| Height        | BRM height                   | BRM height         | BRM height +85             |

**According to clear passage**

| Clear passage dimension<br>Ordering size<br>width × height | Structural opening<br>(Fitting in front of<br>the opening)<br>width × height | Structural opening<br>(fitting in<br>the opening)<br>width × height |
|--|--|---|
| <b>Single-leaf</b>   |  |   |
| 800 × 1850   | 810 × 1855   | 950 × 1923  |
| 800 × 2000   | 810 × 2005   | 950 × 2073  |
| 800 × 2025   | 810 × 2030   | 950 × 2098  |
| 800 × 2100   | 810 × 2105   | 950 × 2173  |
| 850 × 1850   | 860 × 1855   | 1000 × 1923   |
| 850 × 2000   | 860 × 2005   | 1000 × 2073   |
| 850 × 2025   | 860 × 2030   | 1000 × 2098   |
| 850 × 2100   | 860 × 2105   | 1000 × 2173   |
| 1000 × 1850  | 1010 × 1855  | 1150 × 1923   |
| 1000 × 2000  | 1010 × 2005  | 1150 × 2073   |
| 1000 × 2025  | 1010 × 2030  | 1150 × 2098   |
| 1000 × 2100  | 1010 × 2105  | 1150 × 2173   |
| <b>Double-leaf</b>   |  |   |
| 1600 × 2000  | 1610 × 2005  | 1750 × 2073   |
| 1800 × 2000  | 1810 × 2005  | 1950 × 2073   |
| 2000 × 2000  | 2010 × 2005  | 2150 × 2073   |
| 2000 × 2100  | 2010 × 2105  | 2150 × 2173   |

# Frame Type

## Adjustable frame with plug-and-screw fitting



### Adjustable frame, type A

Fitting distance 0-25 mm, (12.5 mm per side)

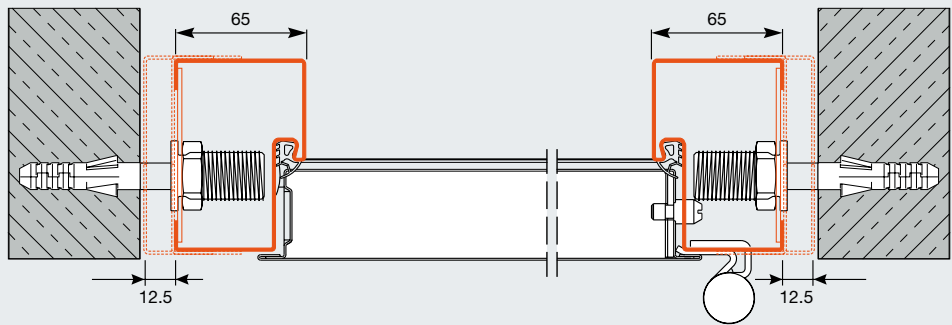
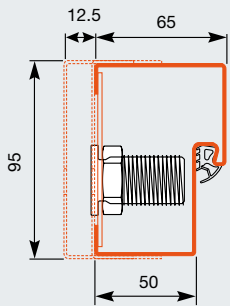

### Adjustable frame, type B

Fitting distance 25-50 mm, (12.5 mm per side)

