



# Steel Fire-Rated Doors to British Standard

Single and double-leaf doors in a matching appearance -  
with Environmental Product Declaration EPD



# Hörmann Fire Protection

Because it's good to be on the safe side



Allianz Arena Munich, Germany



## In-house product development

Reliable fire protection calls for adequate new developments and improvements to each and every detail. This is where our qualified development teams demonstrate their expertise time and again. Hörmann has continually extended its fire protection programme. Today, as a result, we can offer a complete and fully developed range.



## State-of-the-art production

Hörmann relies on the latest production technology at highly specialised factories. Computer-controlled operations ensure dimensionally accurate elements with perfectly installed fittings and functional parts. This is a prerequisite for customised solutions in the non-domestic building sector.



When you purchase a Hörmann fire-rated door you are assured of quality, protection and safety for decades. Take advantage of our comprehensive range to meet the special requirements of your application in the non-domestic building sector.

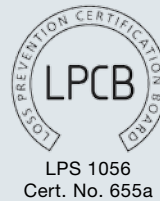

LPCB Certificate valid for:  
 HBS 60 C-1, HBS 60 C-2,  
 HBS 90 C-1, HBS 90 C-2,  
 HBS 90 D-1, HBS 90 F-2,  
 HBS 120 C-1, HBS 120 C-2

LPS 1056  
 Cert. No. 655a



### Pre-tested in Hörmann's own fire-testing center

In our own fire-testing center, highly sensitive instruments precisely measure the thermal load. This allows us to optimally prepare our innovations for official inspections by accredited testing centres for approvals.



### Competent advice and support

Experienced specialists from our customer-oriented sales organisation support you from the planning stage, through technical clarification up to the final building inspection. Our complete documentation is continually updated and available at all time on our website [www.hoermann.com](http://www.hoermann.com)

# Matching looks down to the last detail

Independent of their functions, all doors have a perfectly matching appearance. The result is a harmonious overall look.

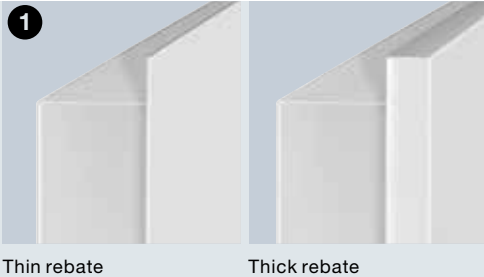

Thin rebate

Thick rebate

- 1 Rebate type**  Hörmann steel fire-rated doors are available with a thin rebate (standard) or a thick rebate.

- 2 Surface**  Door leaves and frames are galvanized and powder-coated in Grey white (similar to RAL 9002). Optionally available in RAL to choose.

- 3 Lock** Hörmann steel fire-rated doors are equipped as standard with a lever/knob mortice lock and prepared for a profile cylinder to DIN 18250. Break-in resistant doors rated RC 3 and higher are fitted with a multiple locking system. With double-leaf doors the fixed leaf is secured with a rebate latch or rebate locking bolt at the top and bottom depending on the function.

- 4 Lever handle set** Hörmann steel fire-rated doors are equipped as standard with an FS round lever handle set according to DIN 18273 in black (polypropylene), with a short escutcheon, a securely fitted knob and a deadlock insert with a key. HBS C-doors are equipped with FS round lever handle set in aluminium. Break-in resistant doors are supplied with an FS security lever/knob handle set to DIN 18257, class ES1 (with short escutcheon) or ES2/ES3 (with long escutcheon).



## Exclusive slide rail door closer HDC 35

### 5 Closing devices



Fire-rated doors close automatically as standard. With single-leaf doors a spring hinge closes the door. For British standard doors overhead door closers are needed. Depending on the size, features, use or fitting style, the factory can also supply you with single-leaf doors with the exclusive slide rail door closer HDC 35 and double-leaf doors with linkage door closers and door leaf selector.



Exclusive slide rail door closer HDC 35  
For single-leaf doors (on request also for double-leaf doors).



Linkage door closer for double-leaf doors.

### 6 Hinges



Hörmann steel fire-rated doors are supplied with heavy-duty ball-bearing hinge sets. Depending on the size of the door, each door leaf is fitted with 2 or 3 hinges. Stainless steel hinge sets can also be supplied up to resistance class RC 3.

#### Optional 3-D hinges

3-D hinges are especially suited for the fine-tuning and subsequent adjustment of the door. You can balance out minor fitting tolerances. Available galvanized, powder-coated or in stainless steel.



Standard hinge

3-D hinge galvanized and primed

### 7 Security bolts

On fire-rated and smoke-tight doors, steel security bolts on the hinge side provide additional stability in the case of a fire. Break-in-resistant door models to DIN EN V 1627 are secured on the hinge side against being levered open by up to 7 solid steel security bolts per door leaf, depending on the resistance class.



Security bolt

# Do you have a specific requirement? Then Hörmann is the right partner for you.



## Lever handle sets



Operational requirements and individual wishes demand a comprehensive range of fittings in the facility. Fittings in the form of knobs, levers or anti-panic handle sets with short escutcheon or roses with various handle shapes is available. Surfaces are available in differently coloured plastic versions, aluminium F1 and stainless steel (break-in resistant doors can only be equipped with fittings to DIN 18257 resistance classes).

Ironmongery supplied must be approved to the respective guidelines of the relevant assessment report.

## Locks



In addition to the normal use of a door, the facility requires special lock functions or additional locks. Optional special and additional locks:

- Double cylinder lock (locked with 2 different cylinders)
- Bolt lock, additionally prepared for profile cylinder
- Block lock
- Motor lock
- Anti-panic lock self-locking

## Emergency exit locks Panic door locks



Specific hardware and lock fittings are stipulated for escape doors to DIN EN 179 and DIN EN 1125. Hörmann offers you a wide range of different equipment for your respective needs.

### Emergency exit locks according to DIN EN 179

- Fittings in the form of anti-panic or lever / knob handle sets with short escutcheon or rose with matching handles
- Anti-panic lock DIN EN 179
- Anti-panic lock self-locking

### Panic locks according to DIN EN 1125

- Fittings with a bar or a handle bar combined with a variety of lever handle sets tested to DIN EN 1125
- Anti-panic lock DIN EN 1125 with different functions

Hörmann quality means all options are designed for a perfect fit and attractive look for safe and long lasting performance.



#### Door closers



Modern door closer systems allow secure and low-noise closing of the door elements in everyday use.

- Overhead door closer with lever arm
- Overhead door closer with slide rail
- Integrated door closer (concealed fitting)

These systems are available in silver (standard), in RAL to choose or in stainless steel

#### Hold-open devices / operators



Fire and smoke-protection doors must be equipped with a special means of closing that ensures that they close automatically. By using hold-open devices, automatic closing can be put out of action in a controlled manner and doors permanently held open.

- Magnets for wall or floor fitting
- Overhead door closer with lever arm and electromechanical hold-open device
- Overhead door closer with slide rail and electromagnetic hold-open device
- Integrated door closer with electromechanical hold-open device
- Hinged leaf operator

#### Electrical equipment



In the facility, door systems are often equipped with alarm, escape-route security or access control systems. Various components are available according to your needs:

- Latch contact
- Reed contact
- Electric door strike
- Escape door opener
- Alarm wire mesh
- Motor lock
- Door lock
- Concealed electro duct

**O-14 Tower, Business Bay, Dubai**  
**Architects: Reiser and Umemoto Architects**



**Hörmann products**  
O-14 Tower, Dubai  
Strong Fire Protection for  
High Rise Buildings  
HBS90  
HBS120  
British Standard Doors  
Two hinges with aluminium ironmongery.

# Fire-Rated Doors

## HBS 30 A-1 / -2, HBS 60 A-1 / -2

Single and double-leaf

**Sustainability tested and documented by the IFT**



**Thin rebate on 2 sides**  
Door leaf 45 mm thick



**HBS 30 A-1**  
Assessment report number CC 229620  
**HBS 30 A-2**  
Assessment report number CC 260925



**HBS 60 A-1**  
Assessment report number CC 229618  
**HBS 60 A-2**  
Assessment report number CC 260925



**Dual-handed with corner frame**

You determine the handing on-site - LH or RH hinged.  
You simply turn the doors around. No need to remove and relocate bolts - a quick fitting method!

**Hörmann was the first manufacturer who received confirmation of the sustainability of all its multi-function doors through an environmental product declaration (EPD)\* in accordance with ISO 140425 from the Institut für Fenstertechnik (ift - Institute of window technology) in Rosenheim.**



**HBS 30 A-1**  
**HBS 60 A-1**

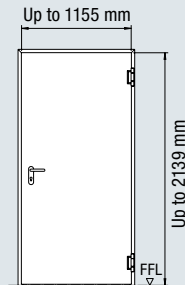

**HBS 30 A-2**  
**HBS 60 A-2**

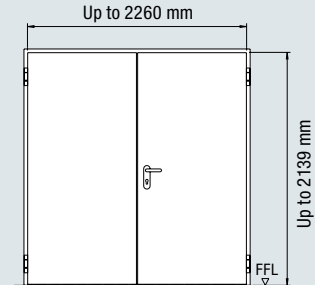

Fire-rated door	HBS 30 A-1	HBS 60 A-1	HBS 30 A-2	HBS 60 A-2
Door leaf	45 mm	45 mm	45 mm	45 mm
Sheet thickness	0.9 mm	0.9 mm	0.9 mm	0.9 mm
Rebate	Thin rebate	Thin rebate	Thin rebate	Thin rebate

### Standard equipment

<b>Door leaf</b>	Thermal insulation: mineral wool board, 2 steel security bolts on the hinge side, intumescent seal
<b>Frame</b>	Special corner frame with all-round sealing (on 4 sides) Counter frame for wall width 100 to 330 mm Block frame in the reveal with 6 fixing points per side Aluminium threshold profile with seal
<b>Surface finish</b>	Door leaf and corner frame galvanized and primed in RAL 9002 Grey white Block frame in the reveal galvanized and primed in RAL 7035 Light grey
<b>Hinges</b>	Spring hinge, hinge acc. to DIN 18272
<b>Fittings</b>	Mortice lock with lever/knob - prepared for profile cylinder FS round lever handle set with lever securely fitted, panic bar handle
<b>Product benefits</b>	Acoustic-rated, guide value P approx. 39 dB (corner frame) Thermally insulated U = 1.7 W/m²K (corner frame) Dual-handed (corner frame) All-round sealing (corner frame) 2 steel bolts to prevent door from being levered open Available for finished floor
<b>Accessories</b>	Door leaf in chosen RAL colour Frame in chosen RAL colour Door set with counter frame Aluminium threshold with seal Black BKS bar handle with knob Black BKS bar handle with lever

Structural opening (ordering size)	HBS 30 A-1 / HBS 60 A-1		HBS 30 A-2 / HBS 60 A-2	
	Width	Height	Width	Height
Corner frame	635 - 1155	1755 - 2139	1300 - 2260	1755 - 2139
Clear passage	557 - 1077	1716 - 2100	1222 - 2182	1716 - 2100
Reveal frame	707 - 1332	1789 - 2173	1332 - 2260	1789 - 2170
Clear passage	567 - 1192	1719 - 2103	1192 - 2120	1719 - 2100

# Fire-Rated Doors

## HBS 30 A-1 / -2, HBS 60 A-1 / -2

### Standard sizes

#### Standard sizes with corner frame

Single-leaf	
Structural opening (ordering size)	Clear passage
800 x 2000	722 x 1961
800 x 2100	722 x 2061
900 x 2000	822 x 1961
900 x 2100	822 x 2061
1000 x 2000	922 x 1961
1000 x 2100	922 x 2061

Double-leaf	
Structural opening (ordering size)	Clear passage
1400 x 2000	1322 x 1961
1600 x 2000	1522 x 1961
1800 x 2000	1722 x 1961
2000 x 2000	1922 x 1761
1400 x 2100	1322 x 2061
1600 x 2100	1522 x 2061
1800 x 2100	1722 x 2061
2000 x 2100	1922 x 2061

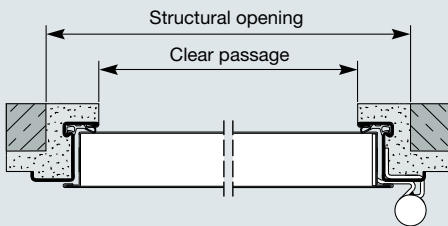
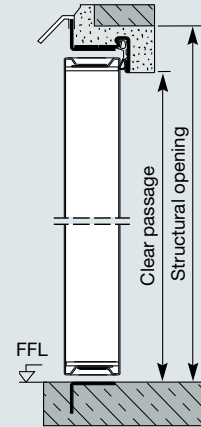

Single-leaf with corner frame

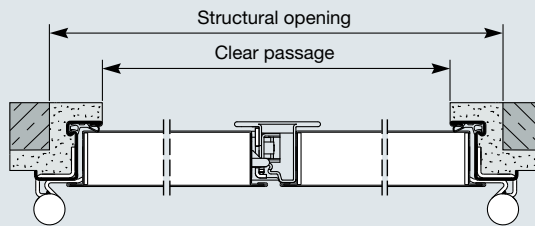

Double-leaf with corner frame

#### Standard sizes with reveal frame

Single-leaf	
Structural opening (ordering size)	Clear passage
800 x 2000	660 x 1930
800 x 2100	660 x 2030
900 x 2000	760 x 1930
900 x 2100	760 x 2030
1000 x 2000	860 x 1930
1000 x 2100	860 x 2030

Double-leaf	
Structural opening (ordering size)	Clear passage
1400 x 2000	1260 x 1930
1600 x 2000	1460 x 1930
1800 x 2000	1660 x 1930
2000 x 2000	1860 x 1930
1400 x 2100	1260 x 2030
1600 x 2100	1460 x 2030
1800 x 2100	1660 x 2030
2000 x 2100	1860 x 2030

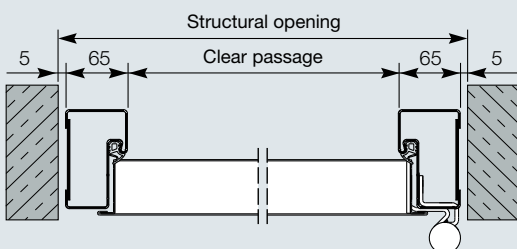
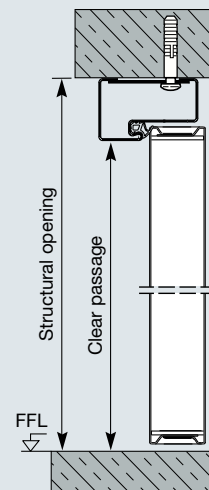

Single-leaf with reveal frame

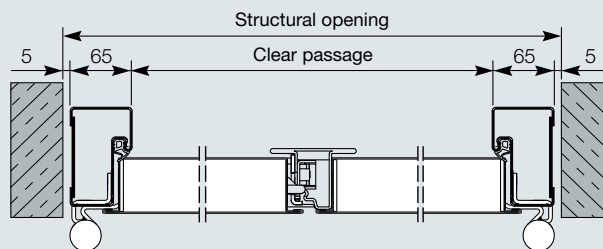

Double-leaf with reveal frame

# Fire-Rated Doors

## HBS 30 A-1 / -2, HBS 60 A-1 / -2

### Frame types and fitting situations

**Frame type**

**Fitting situation**

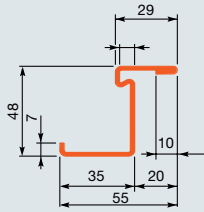

Corner frame

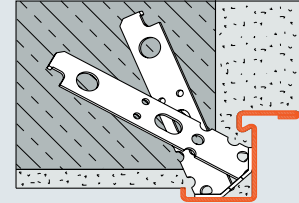
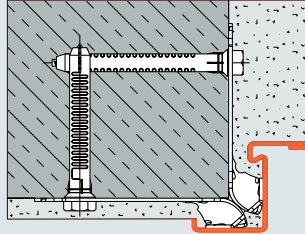

Fitting with grouting lugs / anchor brackets

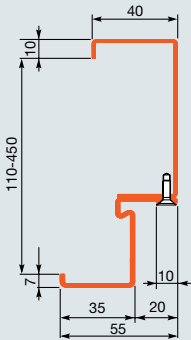

Corner frame with counter frame

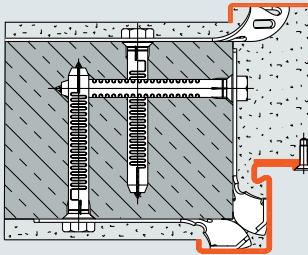

Fitting with grouting lugs / anchor brackets

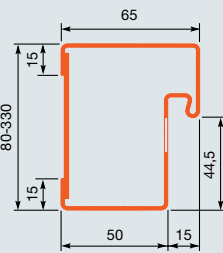

Block frame type 1

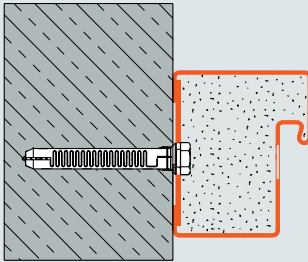

Fitting in the opening

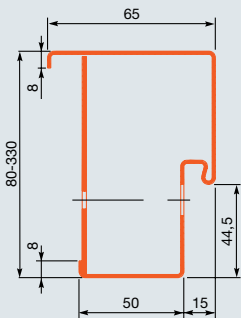

Block frame type 2

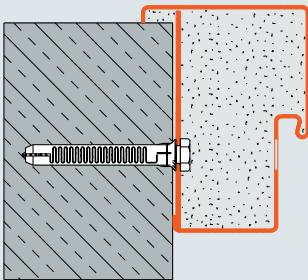

Fitting in the opening

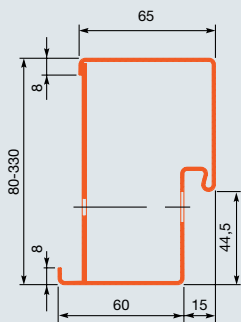

Block frame type 3

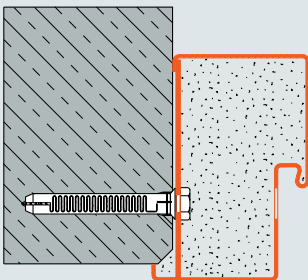

Fitting in the opening

**BMW Welt, Munich, Germany**  
**Architects: Coop Himmelb(l)au, Vienna, Austria**



**Hörmann products**  
BMW Welt:  
High-acoustic-rating doors  
BMW high rise:  
T30 steel fire-rated doors  
T90 steel fire-rated doors  
T30 security doors WK 4  
Steel doors  
Fire sliding doors  
Industrial sectional doors

# Fire-Rated Door HBS 60 C-1 / -2

Single and double-leaf

**Sustainability tested and  
documented by the IFT**



**Thin rebate**  
Door leaf 55 mm thick



**Thick rebate**  
Door leaf 55 mm thick



**HBS 60 C-1 / -2**



LPS 1056  
Cert. No. 655a

Hörmann was the first manufacturer who received confirmation of the sustainability of all its multi-function doors through an environmental product declaration (EPD)\* in accordance with ISO 140425 from the Institut für Fenstertechnik (ift – Institute of window technology) in Rosenheim.



**HBS 60 C-1**

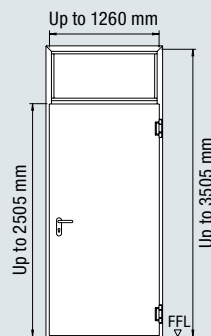

**HBS 60 C-2**

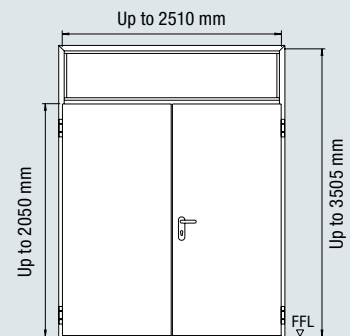

Fire-rated door	HBS 60 C-1	HBS 60 C-2
Door leaf	55 mm	55 mm
Sheet thickness	1.0 mm/1.5 mm	1.0 mm/1.5 mm
Rebate	Thin rebate/thick rebate	Thin rebate/thick rebate

#### Standard equipment

<b>Door leaves</b>	Rebated on 3 sides
<b>Frame</b>	System corner frame 2.0 mm thick, 30 mm floor recess Chloroprene sealing profile Welded-on grouting lugs / anchor brackets
<b>Surface</b>	Door leaf and frame galvanized and powder-coated with a primer in Grey white (based on RAL 9002).
<b>Lock</b>	Mortice lock with lever / knob DIN 18250 prepared for profile cylinder Deadlock insert with key
<b>Handle set</b>	Fire-proof round handle / lever handle set in aluminium F1 (lever handle pivoted on bearing) with short escutcheons Can be used for profile cylinder and deadlock key
<b>Hinges</b>	3-part construction hinges with ball bearings
<b>Closing devices</b>	HBS 60 C-1: door closer HBS 60 C-2: 2 door closer with leaf selector
<b>Security bolts</b>	1 steel bolt (over a height of 1880 mm with 2 bolts, over a height of 2005 mm with 3 bolts)
<b>Fitting to</b>	Brickwork at least 215 mm thick Concrete or concrete block walls at least 150 mm thick Autoclaved aerated concrete block walls, minimum 600 kg/m <sup>3</sup> density, at least 215 mm thick Plasterboard or calcium silicate board partitions

	HBS 60 C-1		HBS 60 C-2	
	Width	Height	Width	Height
<b>Structural opening (ordering size)</b>	635 - 1260	1755 - 2505	1385 - 2510	1755 - 2505
<b>Maximum structural opening with transom panel</b>		- 3505		- 3505

# Fire-Rated Door HBS 90 C-1 / -2

## Single and double-leaf

**Sustainability tested and  
documented by the IFT**



### Thin rebate

Door leaf 55 mm thick



### Thick rebate

Door leaf 55 mm thick

**FD90**

HBS 90 C-1 / -2



LPS 1056  
Cert. No. 655a

Hörmann was the first manufacturer who received confirmation of the sustainability of all its multi-function doors through an environmental product declaration (EPD)\* in accordance with ISO 140425 from the Institut für Fenstertechnik (ift – Institute of window technology) in Rosenheim.



HBS 90 C-1

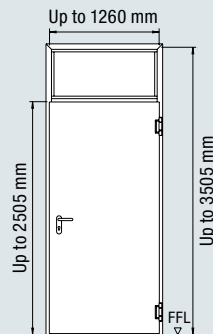

HBS 90 C-2

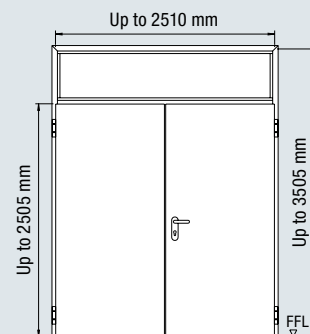

Fire-rated door	HBS 90 C-1	HBS 90 C-2
Door leaf	55 mm	55 mm
Sheet thickness	1.0 mm/1.5 mm	1.0 mm/1.5 mm
Rebate	Thin rebate/thick rebate	Thin rebate/thick rebate

### Standard equipment

<b>Door leaves</b>	Rebated on 3 sides
<b>Frame</b>	System corner frame 2.0 mm thick, 30 mm floor recess Chloroprene sealing profile Welded-on grouting lugs / anchor brackets
<b>Surface</b>	Door leaf and frame galvanized and powder-coated with a primer in Grey white (based on RAL 9002).
<b>Lock</b>	Mortice lock with lever / knob DIN 18250 prepared for profile cylinder Deadlock insert with key
<b>Handle set</b>	Fire-proof round handle / lever handle set in aluminium F1 (lever handle pivoted on bearing) with short escutcheons Can be used for profile cylinder and deadlock key
<b>Hinges</b>	3-part construction hinges with ball bearings
<b>Closing devices</b>	HBS 90 C-1: door closer HBS 90 C-2: 2 door closer with leaf selector
<b>Security bolts</b>	1 steel bolt (over a height of 1880 mm with 2 bolts, over a height of 2005 mm with 3 bolts)
<b>Fitting to</b>	Brickwork at least 215 mm Concrete walls at least 150 mm Partition walls 150 mm Gas concrete (stone slabs or concrete precision blocks) Strength class G4-GP4 at least 175 mm thick Gas concrete as reinforced slabs Strength class G4 at least 175 mm thick Plasterboard or calcium silicate board partitions

	HBS 90 C-1		HBS 90 C-2	
	Width	Height	Width	Height
Structural opening (ordering size)	635 - 1260	1755 - 2505	1385 - 2510	1755 - 2505
Maximum structural opening with transom panel		- 3505		- 3505

# Fire-Rated Doors

## HBS 90 D-1, HBS 90 F-2

Single and double-leaf oversized doors

*Sustainability tested and documented by the IFT*



Thin rebate



HBS 90 D-1  
HBS 90 F-2



LPS 1056  
Cert. No. 655a

Hörmann was the first manufacturer who received confirmation of the sustainability of all its multi-function doors through an environmental product declaration (EPD)\* in accordance with ISO 140425 from the Institut für Fenstertechnik (ift – Institute of window technology) in Rosenheim.



HBS 90 D-1

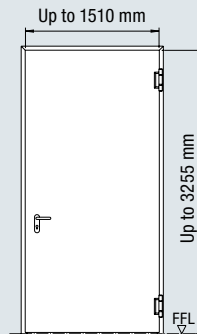

HBS 90 F-2

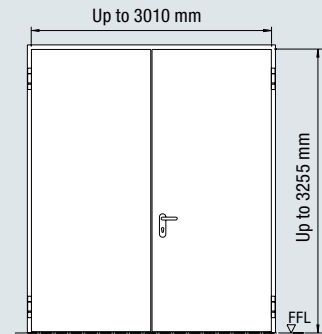

Fire-rated door	HBS 90 D-1	HBS 90 F-2
Door leaf	65 mm	78 mm
Sheet thickness	1.5 mm	1.5 mm
Rebate	Thin rebate	Thin rebate

#### Standard equipment

<b>Door leaves</b>	Rebated on 3 sides
<b>Frame</b>	System corner frame 2.0 mm thick, 30 mm floor recess Chloroprene sealing profile Welded-on grouting lugs / anchor brackets
<b>Surface</b>	Door leaf and frame galvanized and powder-coated with a primer in Grey white (based on RAL 9002).
<b>Lock</b>	Mortice lock with lever / knob DIN 18250 prepared for profile cylinder Deadlock insert with key
<b>Handle set</b>	Fire-proof round handle / lever handle set (lever handle pivoted on bearing) with short escutcheons Can be used for profile cylinder and deadlock key
<b>Hinges</b>	3-part construction hinges with ball bearings
<b>Closing devices</b>	HBS 90 D-1 : door closer HBS 90 F-2: 2 door closer with leaf selector
<b>Security bolts</b>	1 steel bolt (over a height of 1880 mm with 2 bolts, over a height of 2005 mm with 3 bolts) HBS 90 F-2: 3 steel bolts
<b>Fitting to</b>	Brickwork at least 215 mm Concrete walls at least 150 mm Partition walls 150 mm Gas concrete (stone slabs or concrete precision blocks) Strength class G4-GP4 at least 175 mm thick Gas concrete as reinforced slabs Strength class G4 at least 175 mm thick

	HBS 90 D-1		HBS 90 F-2	
	Width	Height	Width	Height
<b>Structural opening (ordering size)</b>	635 - 1510	1755 - 3255	1385 - 3010	1755 - 3255

# Fire-Rated door

## HBS 120 C-1 / -2

### Single and double-leaf

**Sustainability tested and documented by the IFT**



#### Thin rebate

Door leaf 55 mm thick



#### Thick rebate

Door leaf 55 mm thick



#### HBS 120 C-1 / -2



LPS 1056  
Cert. No. 655a

Hörmann was the first manufacturer who received confirmation of the sustainability of all its multi-function doors through an environmental product declaration (EPD)\* in accordance with ISO 140425 from the Institut für Fenstertechnik (ift – Institute of window technology) in Rosenheim.



#### HBS 120 C-1

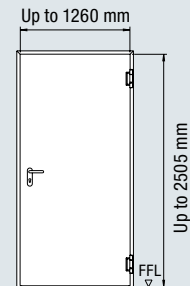

#### HBS 120 C-2

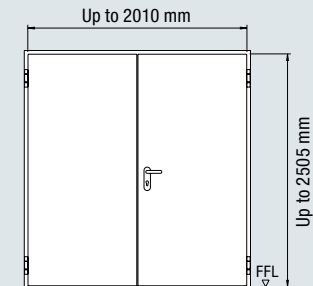

Fire-rated door	HBS 120 C-1	HBS 120 C-2
Door leaf	55 mm	55 mm
Sheet thickness	1.0 mm/1.5 mm	1.0 mm/1.5 mm
Rebate	Thin rebate/thick rebate	Thin rebate/thick rebate

#### Standard equipment

<b>Door leaves</b>	Rebated on 3 sides
<b>Frame</b>	System corner frame 2.0 mm thick, 30 mm floor recess Chloroprene sealing profile Welded-on grouting lugs / anchor brackets
<b>Surface</b>	Door leaf and frame galvanized and powder-coated with a primer in Grey white (based on RAL 9002).
<b>Lock</b>	Mortice lock with lever / knob DIN 18250 prepared for profile cylinder Deadlock insert with key
<b>Handle set</b>	Fire-proof round handle / lever handle set in aluminium F1 (lever handle pivoted on bearing) with short escutcheons Can be used for profile cylinder and deadlock key
<b>Hinges</b>	3-part construction hinges with ball bearings
<b>Closing devices</b>	HBS 120 C-1: door closer HBS 120 C-2: 2 door closer with leaf selector
<b>Security bolts</b>	1 steel bolt (over a height of 1880 mm with 2 bolts, over a height of 2005 mm with 3 bolts)
<b>Fitting to</b>	Brickwork at least 215 mm Concrete walls at least 150 mm Partition walls 150 mm Gas concrete (stone slabs or concrete precision blocks) Strength class G4-GP4 at least 175 mm thick Gas concrete as reinforced slabs Strength class G4 at least 175 mm thick Plasterboard or calcium silicate board partitions

	HBS 120 C-1		HBS 120 C-2	
	Width	Height	Width	Height
<b>Structural opening (ordering size)</b>	635 - 1260	1755 - 2505	1385 - 2010	1755 - 2505

# Fire-Rated Doors

## HBS 60 C-1 / -2, HBS 90 C-1 / -2, HBS 90 D-1, HBS 90 F-2, HBS 120 C-1 / -2

### Standard sizes

#### Standard sizes with corner frame

HBS 60 C-1 Single-leaf	HBS 60 C-2 Double-leaf
Structural opening (ordering size)	Structural opening (ordering size)
800 x 2000	1600 x 2000
900 x 2000	1600 x 2100
1000 x 2000	1600 x 2200
1000 x 2100	1600 x 2500
1000 x 2200	1800 x 2000
1100 x 2100	1800 x 2100
1100 x 2200	1800 x 2200
1100 x 2500	1800 x 2500
1200 x 2100	2000 x 2000
1200 x 2200	2000 x 2100
1250 x 2500	2000 x 2200
	2000 x 2500
	2200 x 2100
	2200 x 2200
	2400 x 2200
	2500 x 2500

HBS 90 C-1 HBS 120 C-1 Single-leaf	HBS 90 C-2 HBS 120 C-2 Double-leaf
Structural opening (ordering size)	Structural opening (ordering size)
800 x 2000	1600 x 2000
900 x 2000	1600 x 2100
1000 x 2000	1600 x 2200
1000 x 2100	1600 x 2500
1000 x 2200	1800 x 2000
1100 x 2100	1800 x 2100
1100 x 2200	1800 x 2200
1100 x 2500	1800 x 2500
1200 x 2100	2000 x 2000
1200 x 2200	2000 x 2100
1250 x 2500	2000 x 2200
	2000 x 2500
	2200 x 2100
	2200 x 2200
	2400 x 2200
	2500 x 2500

HBS 90 D-1 and HBS 90 F-2 are not subdivided into standard sizes. There are only special sizes according to the order.

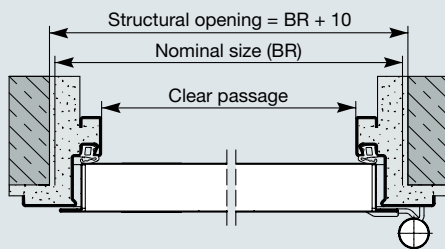

Single-leaf with corner frame

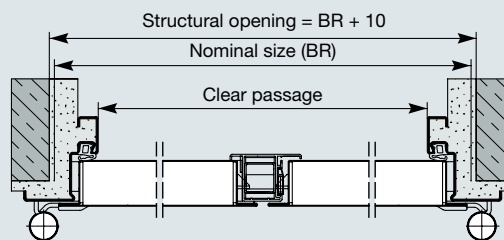

Double-leaf with corner frame

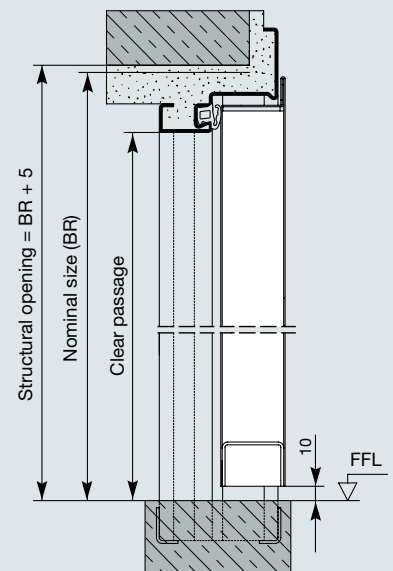

When ordering, please specify LH or RH hinged.

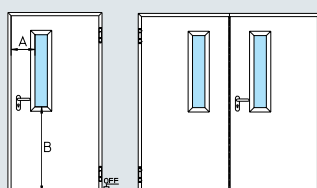

Glazing view 1  
Clear view 140 x 815

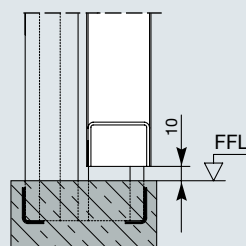

Door bottom edge for flat floor as standard

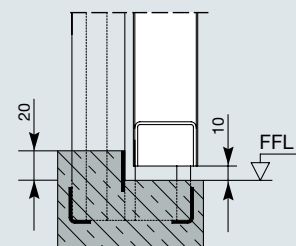

Door bottom edge with stepped threshold, on request or on site

# Fire-Rated Doors

## HBS 60 C-1 / -2, HBS 90 C-1 / -2, HBS 90 D-1, HBS 90 F-2, HBS 120 C-1 / -2

### Frame types and fitting situations

### according to the corresponding assessment reports

#### Frame type

#### Fitting situation

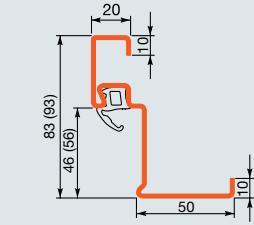

Corner frame

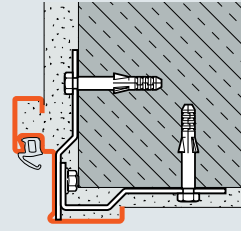

Fitting to brickwork  
Anchor bracket for brickwork

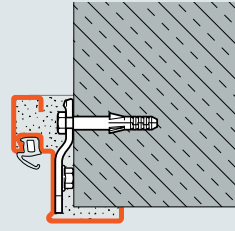

Fitting to unplastered brickwork  
or concrete with anchor brackets

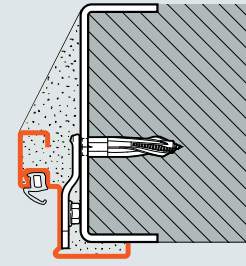

Fitting to gas concrete

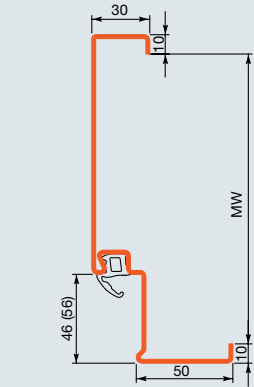

Profile frame

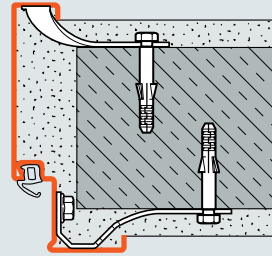

Fitting to brickwork  
Anchor bracket for brickwork

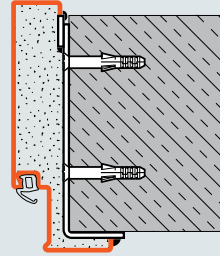

Fitting to unplastered brickwork  
or concrete

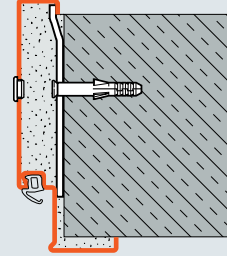

Fitting to unplastered brickwork  
or concrete

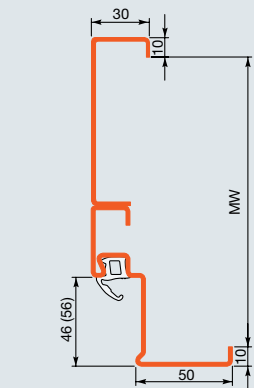

Corner frame with counter frame

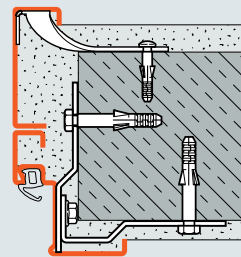

Fitting to brickwork  
Anchor bracket for brickwork

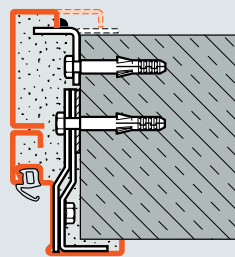

Fitting to unplastered brickwork  
or concrete

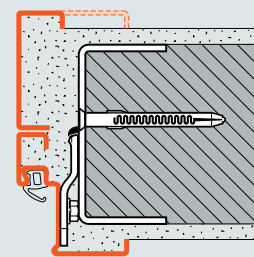

Fitting to gas concrete

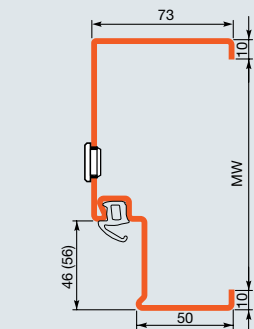

B 73 frame

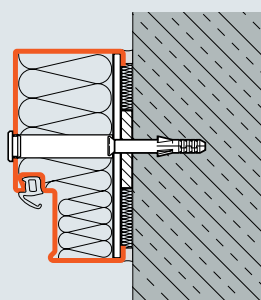

Fitting in the opening  
Anchor bracket up to MW 205 mm

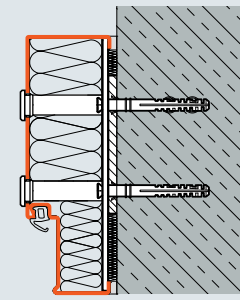

Fitting in the opening  
Anchor bracket from MW 205 mm

# Everything from a Single Source

## For your construction project



**1**  
Sectional doors



**2**  
Rolling shutters and rolling grilles



**3**  
Steel and aluminium folding doors



**4**  
High-speed doors



**5**  
Loading technology



**6**  
Fire sliding doors



**7**  
Multi-function doors and reinforced internal doors



**8**  
Fire and smoke-protection box frame parts



**9**  
Visibility windows



**10**  
Service

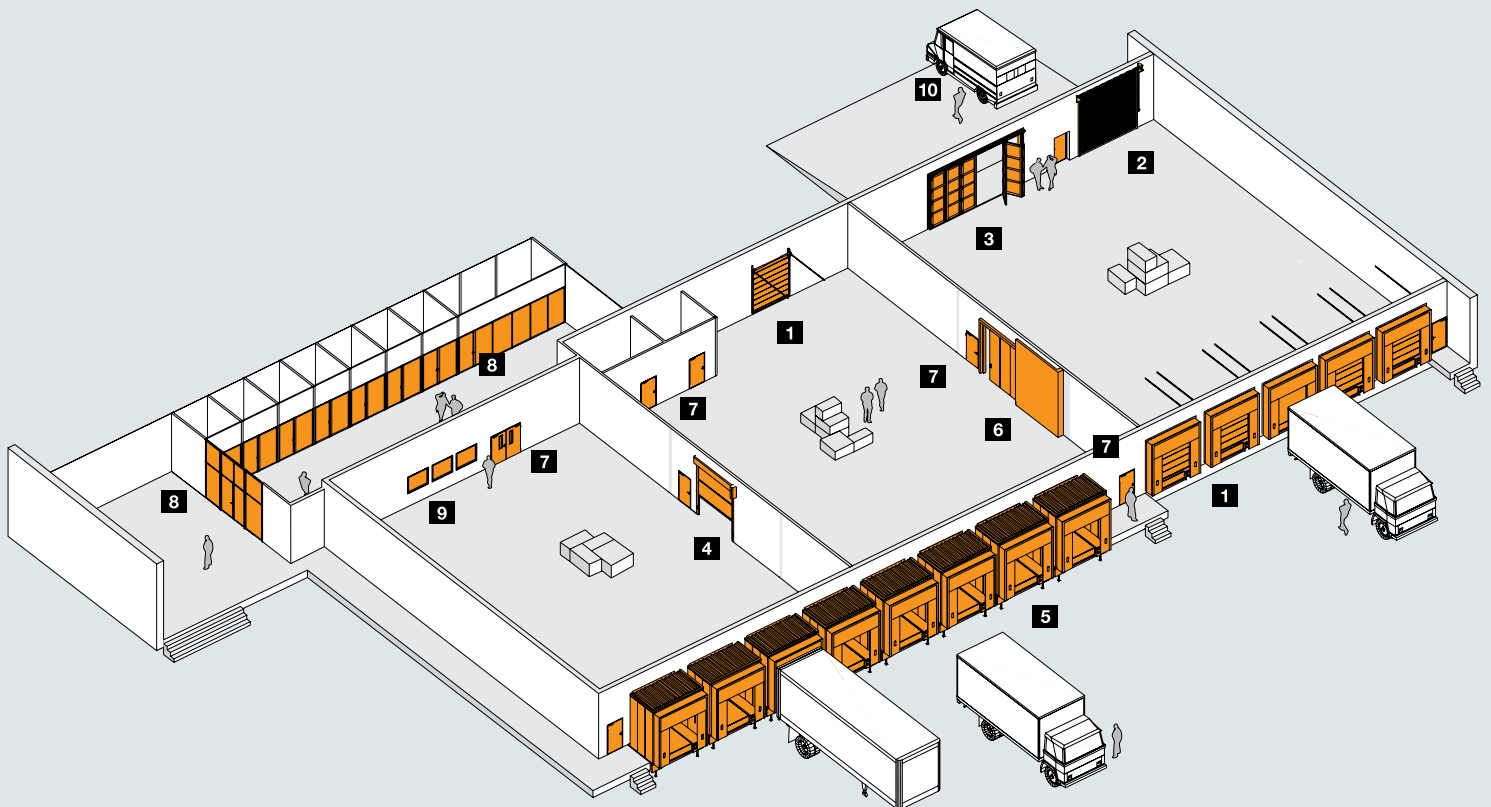

## Hörmann: Quality without Compromise



Hörmann KG Amshausen, Germany



Hörmann KG Antriebstechnik, Germany



Hörmann KG Brandis, Germany



Hörmann KG Brockhagen, Germany



Hörmann KG Dissen, Germany



Hörmann KG Eckelhausen, Germany



Hörmann KG Freisen, Germany



Hörmann KG Ichtshausen, Germany



Hörmann KG Werne, Germany



Hörmann Genk NV, Belgium



Hörmann Alkmaar B.V., Netherlands



Hörmann Legnica Sp. z o.o., Poland



Hörmann Beijing, China



Hörmann Tianjin, China



Hörmann LLC, Montgomery IL, USA



Hörmann Flexon, Leetsdale PA, USA

Hörmann is the only manufacturer worldwide that offers you a complete range of all major building products from one source. We manufacture in highly-specialised factories using the latest production technologies. The close-meshed network of sales and service companies throughout Europe, and activities in the USA and China, make Hörmann your strong partner for first-class building products, offering “Quality without Compromise”.

**GARAGE DOORS**

**OPERATORS**

**INDUSTRIAL DOORS**

**LOADING EQUIPMENT**

**HINGED DOORS**

**DOOR FRAMES**

