



## Product characteristics

### Break-in resistance

★★★★★

### Thermal insulation

★★★★★

### Acoustic insulation

★★

### Fire-retarding

### Stress

★★★★★

### Deformation resistance

★★★★★

### External door for

- Basements
- Heated outbuildings
- Garages with direct access to the home

### Ready-to-fit door set

Door leaf and frame **with thermal break**, galvanized and painted in Traffic white (similar to RAL 9016).

### Single-leaf

### Break-in-resistant WK 2

acc. to DIN V ENV 1627 on opposite hinge side.

### Thermally insulated

$U_D = 1.2 \text{ W/m}^2\text{K}$



Colours and  
Decor Surfaces  
Size Range

Page 21  
Page 24

### Thermal insulation like in an entrance door

These days, saving energy is important throughout the entire home. The KSI Thermo security door provides excellent thermal insulation as the door leaf filled with PU rigid foam, frame and threshold all come with a thermal break. The door also features double seals on all four sides. With all of this, the KSI Thermo has a thermal insulation value usually only found in entrance doors.

### Security as standard

Basement and outbuilding doors are often weak spots when it comes to security. In this respect, the KSI Thermo offers the best equipment as well: 2 conical swing bolts plus 2 additional security bolts and 1 lock bolt engage in the frame's lock plate and firmly pull the door shut. 3 further security bolts and 3 additional hinges make it practically impossible to force the door open.

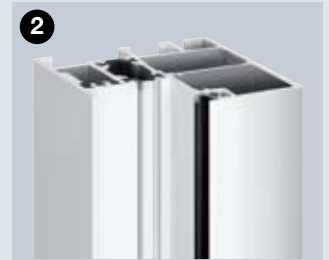

Best thermal insulation thanks to door leaf, frame and threshold with thermal break

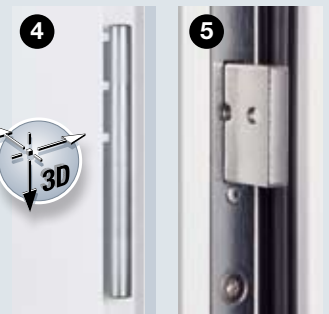

Three-way adjustable hinges for easy door function

Lock bolt for standard security



Swing bolt with security bolt

Security bolts on the hinge side



# KSI Security Door

Additional security with the proven classic



Basement entrances, outbuildings and garages are often equipped with old doors that can be forced open in seconds. Always remember: if the basement door is open, the whole house is accessible. This is why we recommend the KSI security door with standard security equipment for these areas.



## Product characteristics

### Break-in resistance

★★★★★

### Thermal insulation

★★★

### Acoustic insulation

★★

### Fire-retarding

### Stress

★★★★★

### Deformation resistance

★★★★★

### External door for

- Basements
- Unheated outbuildings
- Free-standing garages

### Ready-to-fit door set

Door leaf and frame, galvanized and with powder-coated primer in Traffic white (similar to RAL 9016).

### Single-leaf

### Break-in-resistant WK 2

acc. to DIN V EN V 1627 on hinge side and opposite hinge side.

### Thermally insulated

$U_D = 1.7 \text{ W/m}^2\text{K}$

### Acoustic-rated

with retractable bottom seal  
Rw approx. 32 dB

### Climatic class III

acc. to RAL-RG 426

### Duty category S

acc. to RAL-RG 426



Colours and  
Decor Surfaces  
Size Range

Page 21  
Page 24

### Stable door leaf

The KSI features a double-skinned, 40-mm-thick door leaf with 3-sided thick rebate and sheet steel on both sides (0.8 mm). The stability of the door leaf is a result of the all-round reinforcement frame and the mineral wool insert which is glued over the entire surface. A 3-sided EPDM seal and double lip seal (incl. aluminium semicircular threshold at the bottom) seal the door reliably. This means you can always rely on the door in terms of function and tightness. Hörmann offers this door as a complete set with frame.

### High security

The standard security of the KSI lets you and your family sleep peacefully, as it comes with pull-off protection and a drill-resistant security lever / knob handle set. The solid steel bolts on the hinge side make it almost impossible to force the door open. The KSI has been tested in accordance with European standard DIN V ENV 1627 on the hinge and opposite hinge side and has resistance class 2.



1.5-mm-thick corner frame with all-round seal

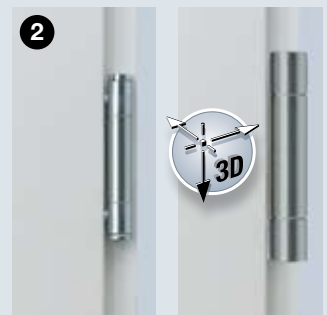

3-piece hinge (standard)

Three-way adjustable VX hinge (on request)



Security lever / knob handle set with drilling and pull-off protection

Lock bolt for standard security



Solid steel security bolts on the hinge side



# MZ Thermo Multi-Purpose Door

External door with thermal break  
and the best thermal insulation values

**NEW**



The new MZ Thermo multi-purpose door is more than just extremely robust. Thanks to a thermal break, it features up to 30% better thermal insulation than a conventional multi-purpose door. It is available with or without glazing and in numerous colours and decor surfaces.



## Product characteristics

### Break-in resistance

★ ★

### Thermal insulation

★ ★ ★ ★ ★

### Acoustic insulation

★ ★

### Fire-retarding

### Stress

★ ★ ★ ★ ★

### Deformation resistance

★ ★ ★ ★ ★

### External door for

- Basements
- Heated outbuildings
- Garages with direct access to the home
- Workshops and hobby rooms

### Ready-to-fit door set

Door leaf and frame **with thermal break**, galvanized and painted in Traffic white (similar to RAL 9016).

### Single-leaf

### Thermally insulated

TPS 011:  $U_D = 1.2 \text{ W/m}^2\text{K}$

TPS 021:  $U_D = 1.4 \text{ W/m}^2\text{K}$

### TPS 021 glazing

Double insulated glazing (24 mm) with a U-value of up to  $1.3 \text{ W/m}^2\text{K}$ . With round-style plastic glazing frame.

### High thermal insulation

The new MZ Thermo multi-purpose door will help you reduce heating losses permanently. The door leaf with PU rigid foam infill, frame and threshold all come with a thermal break. This and the all-round double seals on all four sides make sure the door is perfectly sealed and improves thermal insulation by up to 30% compared to a conventional multi-purpose door.

### Stability and function

The MZ Thermo is exceptionally stable and robust thanks to a 46-mm-thick, fully filled door leaf. The door can be optimally adjusted using the three-way adjustable hinges.

### With or without glazing

On request, the MZ Thermo also comes with glazing to let daylight into your workshop or hobby room. The glazed versions also offer excellent thermal insulation thanks to double insulated glass.



**Best thermal insulation thanks to door leaf, frame and threshold with thermal break**



TPS 011

TPS 021

You may choose from 2 styles: a solid door leaf or with glazing.



**Colours and  
Decor Surfaces**  
**Size Range**

Page 21

Page 24

# MZ Multi-Purpose Door

Stable and inexpensive internal and external door



Proven for over four decades, this multi-purpose door is stable, durable and weather-resistant, making it ideal for inside and outside. The MZ comes in a single-leaf or double-leaf design and is available with glazing on request.

## Product characteristics

### Break-in resistance

★ ★

### Thermal insulation

★ ★ ★

### Acoustic insulation

★ ★ ★

### Fire-retarding

### Stress

★ ★ ★ ★ ★

### Deformation resistance

★ ★ ★ ★ ★

### Internal and external door for

- Unheated outbuildings
- Utility sheds
- Storage rooms

### Ready-to-fit door set

Door leaf and frame, galvanized and with powder-coated primer in Grey white (similar to RAL 9002).

### Single- or double-leaf

### Thermally insulated

$U_D = 1.7 \text{ W/m}^2\text{K}^*$

### Acoustic-rated

Rw approx. 39 dB\*

### Possible additional functions:

#### T30 fire-retarding\*

As an H8-5 fire-rated door up to door size 1000 × 2125 mm (see page 12)

\* For doors without glazing and with corner frame

### Size Range

Page 24

### Stability for you

This ready-to-fit door set is especially robust thanks to a double-skinned, 45-mm-thick door leaf rebated on both sides, a sheet thickness of 0.9 mm, a mineral wool infill and steel reinforcement. The door provides a very high level of security with 2 solid steel security bolts. A 2-mm-thick corner frame with all-round EPDM seal keeps the door shut tight and has a bottom threshold rail that can be easily removed. The door is also available with a block frame and a 3-sided EPDM seal on request.

### More light thanks to glazing

Hörmann also offers its MZ multi-purpose door with glazing. Due to security reasons, this glazing is kept very narrow, but it still lets you benefit from daylight inside. 7-mm wired glass is provided as standard, but 20 mm insulated wired glass with a view of 230 × 1360 mm is also possible. The natural-finish aluminium glazing frame is fastened on the opposite hinge side with glazing beads (optionally on the hinge side).



2-mm-thick corner frame with all-round seal



With glazing on request

